

SERVICE MANUAL

STEREO MINI CASSETTE RECORDER



SANYO

MG-3

(U.S.A.)



SPECIFICATIONS

Cassette recorder section

Tape	Metal, normal tape
Recording system	AC bias, 4-track stereo
Erasing system	Magnet erasing, 2-track
Tape speed	4.75 cm/sec. (1-7/8 i.p.s.)
Rewind and fast forward	
time	Approx. 80 sec. (C-60)
Frequency response	55 — 16,000 Hz (metal)
	55 — 12,000 Hz (normal)
Inputs	MIC: 3.3 kohms (0.4 mV)
Outputs	Headphones: 32 ohms
Output power	40 mW x 2 maximum
Power requirements	DC: 3 V, "AA" (UM-3) battery x 2
	AC adaptor (3CV230, optional)
	Car battery adaptor (CA-30, optional)
Dimensions (Approx.)	136 (W) x 24 (D) x 80.5 (H) mm
	(5-3/8 x 15/16" x 3-3/16")
Weight (Approx.)	350 g (12 ozs.) including batteries.

Headphones section

Type	Velocity dynamic type
Impedance	32 ohms
Frequency response	50 — 20,000 Hz
Weight (Approx.)	32 g not including cord

* Specifications subject to change without notice.

DISASSEMBLY

- (1) Remove bottom lid screws.
- (2) Lift end of bottom lid, and push toward terminal side, and detach.
- (3) Remove top lid screws.
- (4) Take off top lid.
- * Remove the hand strap beforehand.

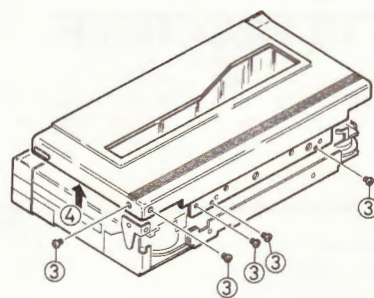
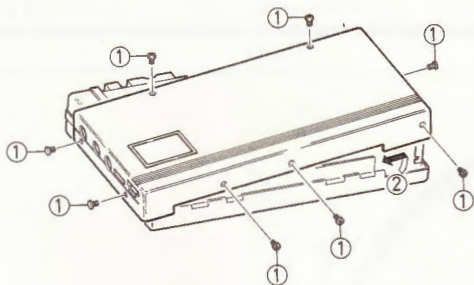

- (5) Disconnect the solder of microphone leads at the PCB side.
- (6) Adhere cellophane tape to the reset button of tape counter.
- (7) Remove front panel screws.
- (8) Press the counter reset button from above the cellophane tape.
- (9) Dismount front panel.
Lift the fixture (A) of hand strap beforehand so that it may not be caught by the front panel when dismounting. Be careful not to drop the switch of tape selector.

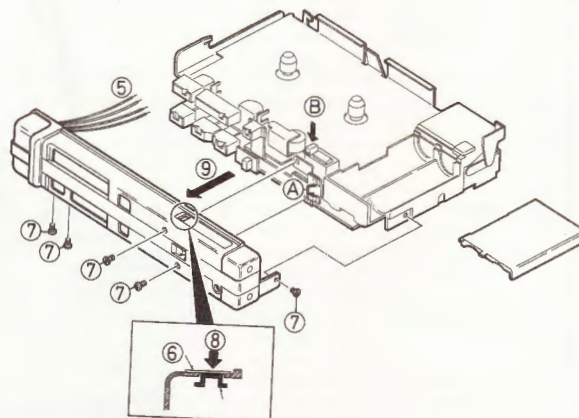

- * When reassembling the front panel, lift the hand strap fixture (inclining slightly to the microphone side), and insert the panel while pushing the knob of counter toward the direction of (B).
- (10) Detach the solder of leads from motor and those from head at the PCB side.
- (11) Remove the PCB screws.
- (12) Dismount the PCB.

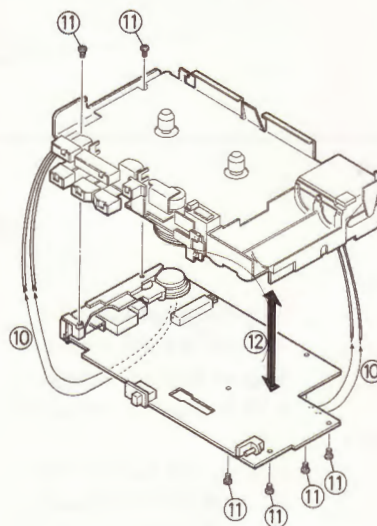

MECHANISM ADJUSTMENT

MOTOR SPEED REGULATION

Play back the test tape (MTT-111, 3 kHz for instance), and turn the SVR located on the MOTOR PCB with screwdriver so that the frequency counter will indicate 3,000Hz.

MECHANISM ADJUSTMENT

HEAD AZIMUTH

After replacing the head, demagnetize (clean) it with head cleanings and head eraser. Play back the test tape for azimuth adjustment (VTT-658, 10 kHz for instance), and turn the azimuth adjusting screw with screwdriver so that the left and right outputs of both SIDE 1 and SIDE 2 of cassette will be maximized.

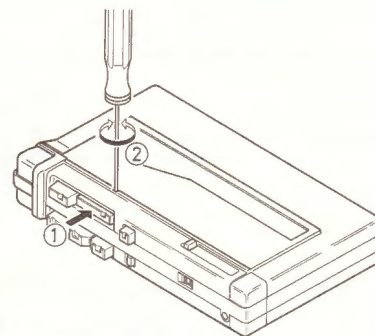

CONFIRMATION OF TORQUE AND TENSIONS

Before confirmation, clean the head, capstan and pinchroller.

Measuring item	Take-up torque	Back tension	Tape tension
Measurement cassette	PLAY: TW-2111 F.FWD/REW: TW-2231	PLAY/F.FWD: TW-2111 REW: Torque gauge	Drive power cassette TW-2412
PLAY	30 ~ 55 gr cm	3 ~ 5 gr cm	Greater than 90 gr
F.FWD	50 ~ 75 gr cm	3 ~ 5 gr cm	—
REW	50 ~ 75 gr cm	2 ~ 6 gr cm	—

AMPLIFIER ADJUSTMENT

● Adjustment of playback level

1. Connect 33-ohm dummy resistor to headphone terminals, and connect VTVM at its both ends.
2. Set tape selector to NORMAL, main volume control to MAX, and balance control to the center, then play back test tape (1 kHz, -10 dB; MTT661, etc.).
Turn SVR701 until the right and left channel levels become equal to each other at the VTVM reading of 420 mV ± 2 dB.

● Adjustment of recording bias

1. Set tape selector to METAL, and connect VTVM at both ends of R801, 901, 10 ohms. (Note: polarity.)
2. With the set in record mode, compare the VTVM indications between right and left channels.
3. Turn SVR703 until the level of the larger VTVM indication side becomes 8.4 mV.

● Adjustment of recording current

1. With the set in record mode, feed 1 kHz, -70 dB (0.3 mV) from the left microphone terminal (L+R).
2. Connect VTVM at both ends of R801, 901 10 ohms. (At this time, the polarity of VTVM connection should be reverse to the setting for recording bias adjustment.)
3. Stop the bias by short-circuiting the base and emitter of transistor Q701.
4. Turn SVR702 until the right and left channel levels become equal to each other with the VTVM indicating -67 dB (0.45 mV) ± 1 dB.

PARTS LOCATION

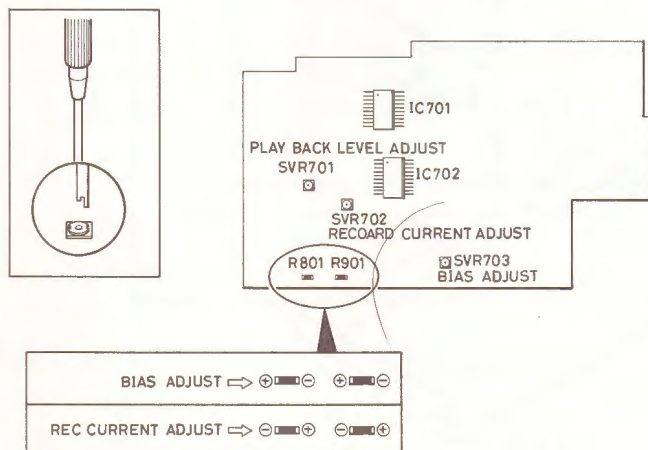

EXPLODED VIEW (CABINET & CHASSIS)

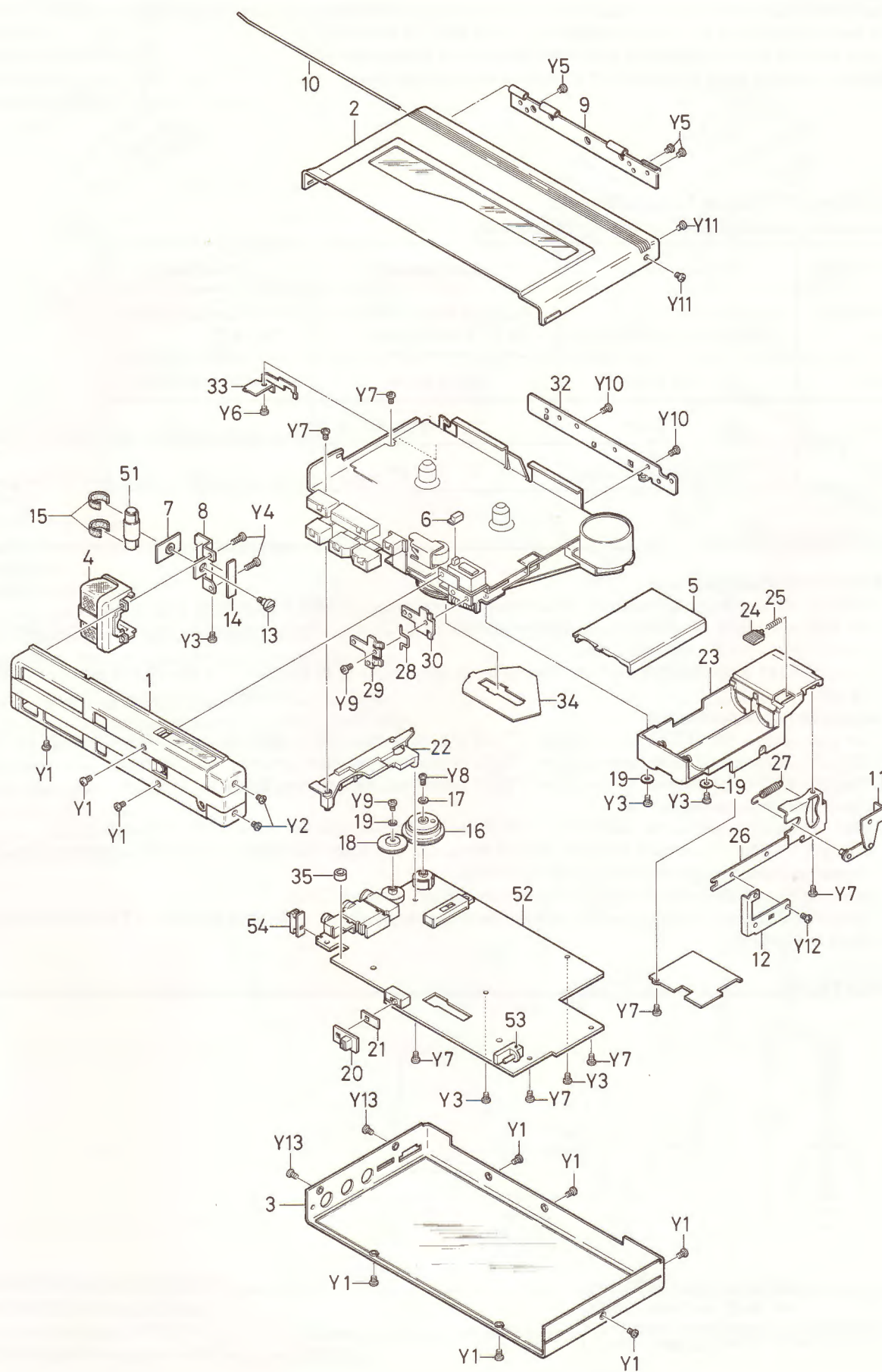

PARTS LIST

Key No.	Part No.	Description	Q'ty
PACKING & ACCESSORIES			
	141-6-141T-16302	Display Carton	1
	141-6-144T-79400	Foam Plastic Case, Up	1
	141-6-144T-79500	Foam Plastic Case, Bottom	1
	141-6-410T-75400	Instruction Manual	1
	141-6-440T-17200	Hang Tag	1
	141-6-415T-30701	Notice	1
	141-2-181T-13401	Case, Set	1
	141-2-176T-06800	Band, Case	1
	141-2-172T-03100	Hanger	1
	141-6-231T-12230	Inner Polye Cover, Set, Case	2
	141-6-231T-11100	Inner Polye Cover, Band, Hanger	2
	141-6-231T-15250	Inner Polye Cover, Inst M	1
	4-152T-04500	Headphone	1
	4-241T-12671	Cassette Tape	1
CABINET & CHASSIS			
1	141-0-122T-42700	Front Panel Ass'y	1
2	141-0-124T-34002	Top Lid Ass'y	1
3	141-0-125T-27602	Bottom Lid Ass'y	1
4	141-0-121T-18200	Deck Panel Ass'y	1
5	141-2-128T-17900	Battery Lid	1
6	141-2-160T-04100	Push Button, Counter	1
7	141-2-310T-75300	Bracket	1
8	141-2-310T-71000	Bracket	1
9	141-2-251T-07600	Hinge	1
10	141-2-754T-14100	Shaft	1
11	141-0-310T-70700	Bracket Ass'y	1
12	141-2-315T-24800	Reinforcement	1
13	141-2-421T-35500	Special Screw	1
14	141-2-447T-95400	Cushion 17x4x1.5t	1
15	141-2-447T-52500	Cushion 27x3.5x3t	2
16	141-2-163T-85400	Rotary Knob, VR	1
17	141-2-457T-41400	Special Washer, VR Knob	1
18	141-2-163T-86000	Rotary Knob, Balance	1
19	141-2-453T-61000	Washer, 1.8x3.5x0.3t	3
20	141-2-164T-29500	Slide Knob, Tape Select	1
21	141-2-352T-55300	Spacer	1
22	141-0-311T-40200	Chassis Ass'y	1
23	141-0-331T-04820	Holder Ass'y, Battery	1
24	141-2-164T-29900	Slide Knob, Battery Lid	1
25	141-2-855T-87200	Spring Coil	1
26	141-2-310T-70600	Bracket, Bottom Lid	1
27	141-2-855T-87400	Spring Coil	1
28	141-2-172T-02600	Hanger	1
29	141-2-272T-01100	Bracket, Hanger	1
30	141-2-310T-70900	Bracket, Hanger	1
32	141-2-310T-70800	Bracket	1
33	141-2-853T-75500	Spring Plate	1
34	141-2-246T-98100	Sheet	1
35	141-2-462T-73100	Boss	1
HARDWARE			
Y01		Pan Hd. Screw, 1.7x3mm	9
Y02		Pan Hd. Screw, 1.4x1.5mm	2
Y03		Pan Hd. Screw, 1.7x3mm	5
Y04		Pan Hd. Tapping Screw, 1.7x5mm	2
Y05		Flat Hd. Screw, 1.4x1.5mm	3
Y06		Pan Hd. Screw, 1.7x2mm	1
Y07		Pan Hd. Tapping Screw, 1.7x4mm	7
Y08		Pan Hd. Screw, 1.4x3mm	1
Y09		Pan Hd. Screw, 1.7x4mm	2
Y10		Flat Hd. Screw, 1.7x2.5mm	2
Y11		Pan Hd. Screw, 1.4x2mm	2
Y12		Pan Hd. Screw, 1.7x1.6mm	1
Y13		Pan Hd. Screw, 1.7x2mm	2
ELECTRICAL PARTS			
51	4-153T-13201 4-153T-13202 4-153T-13203	MIC Ass'y MIC Ass'y } or MIC Ass'y	1
C714		BC Con 0.01μF ±20% 25V	1

Key No.	Part No.	Description	Q'ty
AMP P.C.B. ASS'Y			
52	140-4-250T-30000	P.C.B. Ass'y, AMP	1
	4-235T-68100	Socket, R-Chl Mic	1
	4-240T-07800	Socket, L-Chl Mic, W/Switch	1
	4-240T-07771	Socket, Headphone	1
	4-238T-37671	Switch	1
	4-238T-45000	Switch, EQ	1
	4-238T-20600	Switch, Power	1
	4-222T-97900	Variable Resistor	1
	4-222T-73672	Variable Resistor	1
	4-222T-99873	Semifixed Variable Resistor 1K	1
	4-222T-99877	Semifixed Variable Resistor 22K	1
SVR703	4-222T-55476	Semifixed Variable Resistor 50K	1
	4-258T-34100	OSC Coil, Bias	1
	141-2-853T-77500	Spring Plate	1
	141-2-462T-72800	Boss	1
	141-2-453T-03701	Washer, 2.6x7x3t	1
		IC KB4433A AMP	1
		IC μ PC1217GS Pre AMP	2
Q703		Transistor 2SC536	2
		Transistor 2SC536	1
RESISTORS			
R701		Chip 10 ohms $\pm 5\%$ 1/8W	1
R708		Chip 68 ohms $\pm 5\%$ 1/8W	1
R819,919		Chip 180 ohms $\pm 5\%$ 1/8W	2
R707		Chip 100 ohms $\pm 5\%$ 1/8W	1
R804,904		Chip 1K ohms $\pm 5\%$ 1/8W	2
R802,902		Chip 1.5K ohms $\pm 5\%$ 1/8W	4
818,918			
R705,826		Chip 2.2K ohms $\pm 5\%$ 1/8W	3
926			
R821,921		Chip 3.3K ohms $\pm 5\%$ 1/8W	2
R702,809		Chip 3.9K ohms $\pm 5\%$ 1/8W	3
909			
R704,815		Chip 5.6K ohms $\pm 5\%$ 1/8W	3
915			
R812		Chip 10K ohms $\pm 5\%$ 1/8W	1
R706		Chip 4.7K ohms $\pm 5\%$ 1/8W	1
R820,920		Chip 10K ohms $\pm 5\%$ 1/8W	2
R807,907		Chip 18K ohms $\pm 5\%$ 1/8W	2
R805,905		Chip 22K ohms $\pm 5\%$ 1/8W	4
816,916			
R824,924		Chip 39K ohms $\pm 5\%$ 1/8W	2
R808,908		Chip 47K ohms $\pm 5\%$ 1/8W	3
713			
R817,917		Chip 27K ohms $\pm 5\%$ 1/8W	2
R801,901		Chip 10 ohms $\pm 5\%$ 1/8W	2
R823,923		Chip 180 ohms $\pm 5\%$ 1/8W	2
R703		Chip 330 ohms $\pm 5\%$ 1/8W	1
R825,925		Carbon 2.2K ohms $\pm 10\%$ 1/8W	2
R813,913		Chip 220K ohms $\pm 5\%$ 1/8W	2
R709		Chip 1.8K ohms $\pm 5\%$ 1/8W	1
R710		Chip 2.2 ohms $\pm 10\%$ 1/8W	1
R711		Chip 4.7 ohms $\pm 10\%$ 1/8W	1
R714		Chip 100K ohms $\pm 5\%$ 1/8W	1
R814		Chip 1M ohms $\pm 5\%$ 1/8W	1
R827,927		Chip 470 ohms $\pm 5\%$ 1/8W	3
806			
CAPACITORS			
C826,926		Chip 560pF $\pm 10\%$ 50V	4
837,937			
C818,918		Chip 0.0015 μ F $\pm 20\%$ 50V	2
C831,931		Chip 0.0022 μ F $\pm 20\%$ 50V	4
820,920			
C805,905		Chip 0.0047 μ F $\pm 20\%$ 50V	4
830,930			
C704		Chip 0.015 μ F $\pm 20\%$ 50V	1
C835,925		Chip 820pF $\pm 10\%$ 50V	2
C814,914		Chip 0.1 μ F +80—20% 25V	2
C705,822		Chip 0.0068 μ F $\pm 20\%$ 50V	5
922,834			
934			
C713		Chip 0.01 μ F +80—20% 25V	1
C815,915		Chip 0.033 μ F $\pm 20\%$ 25V	2

PARTS LIST

Key No.	Part No.	Description	Q'ty
AMP P.C.B. ASS'Y			
	CAPACITORS		
C816,916 840,940		Chip 0.001 μ F \pm 20% 50V	4
C712		Chip 0.0022 μ F \pm 20% 50V	1
C839,939		Chip 470pF \pm 10% 50V	2
C838,938		Chip 680pF \pm 10% 50V	2
C715,716		Chip 0.0027 μ F \pm 20% 50V	2
C803,903 823,923		Chip TNTL 1.0 μ F 16V \pm 20%	4
C913		Chip TNTL 1.0 μ F 16V \pm 20%	1
C832,932		Chip TNTL 3.3 μ F 6.3V \pm 20%	2
C817,936		Chip TNTL 4.7 μ F 10V \pm 20%	2
C819,829 929,819		Chip TNTL 22 μ F 6.3V \pm 20%	4
C808,908 811,909		Chip TNTL 10 μ F 16V \pm 20%	4
C824,924		Chip TNTL 0.47 μ F 25V \pm 20%	2
C809		Chip TNTL 10 μ F 6.3V \pm 20%	1
C806,906 813,825 925		Tantal 1 μ F 10V \pm 20%	5
C706		Tantal 33 μ F 3.15V \pm 20%	1
C810,812		Tantal 47 μ F 3.15V \pm 20%	2
C833,933		Tantal 68 μ F 3.15V \pm 20%	2
C828,928		Tantal 1 μ F 10V \pm 20%	2
C917,911 707		Electrolytic 10 μ F 16V	3
C701,919		Electrolytic 22 μ F 6.3V	2
C703,910 708,709		Electrolytic 47 μ F 6.3V	4
C711		Electrolytic 100 μ F 6.3V	1
C801,901		Chip 0.1 μ F \pm 20% 25V	2
C710		Capacitor 220 μ F 6.3V	1
C802,902		Chip 0.1 μ F \pm 20% 25V	2
C702		Mylar 0.0033 μ F \pm 5% 50V	1
SOCKET P.C.B. ASS'Y			
53	141-4-250T-30100 4-235T-93300	P.C.B. Ass'y, Socket Socket	1 1
LED P.C.B. ASS'Y			
54	141-4-250T-30200 141-2-210T-38000	P.C.B. Ass'y, LED LED SR506D RED Bracket, LED	1 1 1

SCHEMATIC DIAGRAM

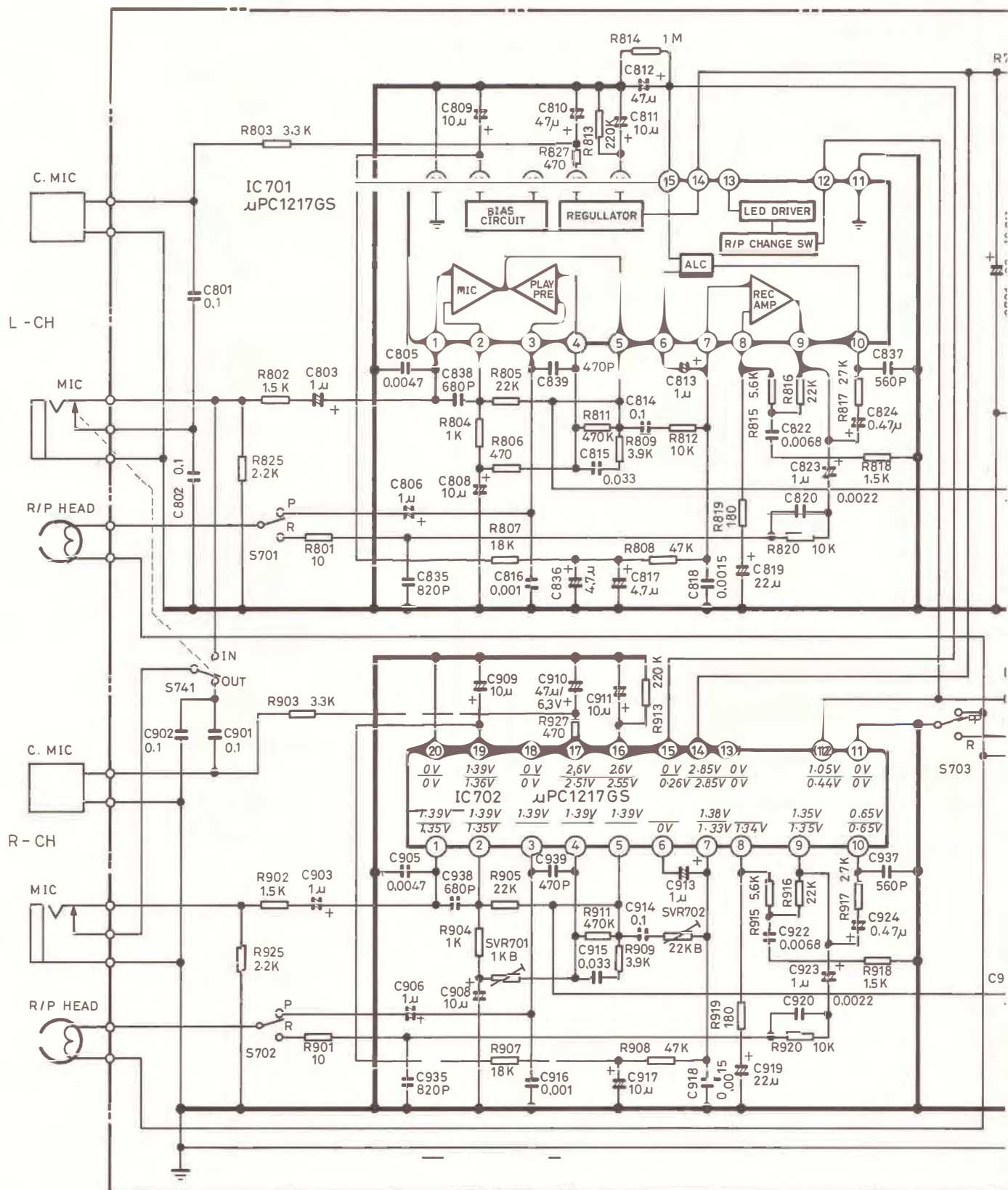

VOLTAGE INDICATED IN $\frac{\text{PLAY}}{\text{REC}}$ MODE
OTHERS -----PLAY MODE

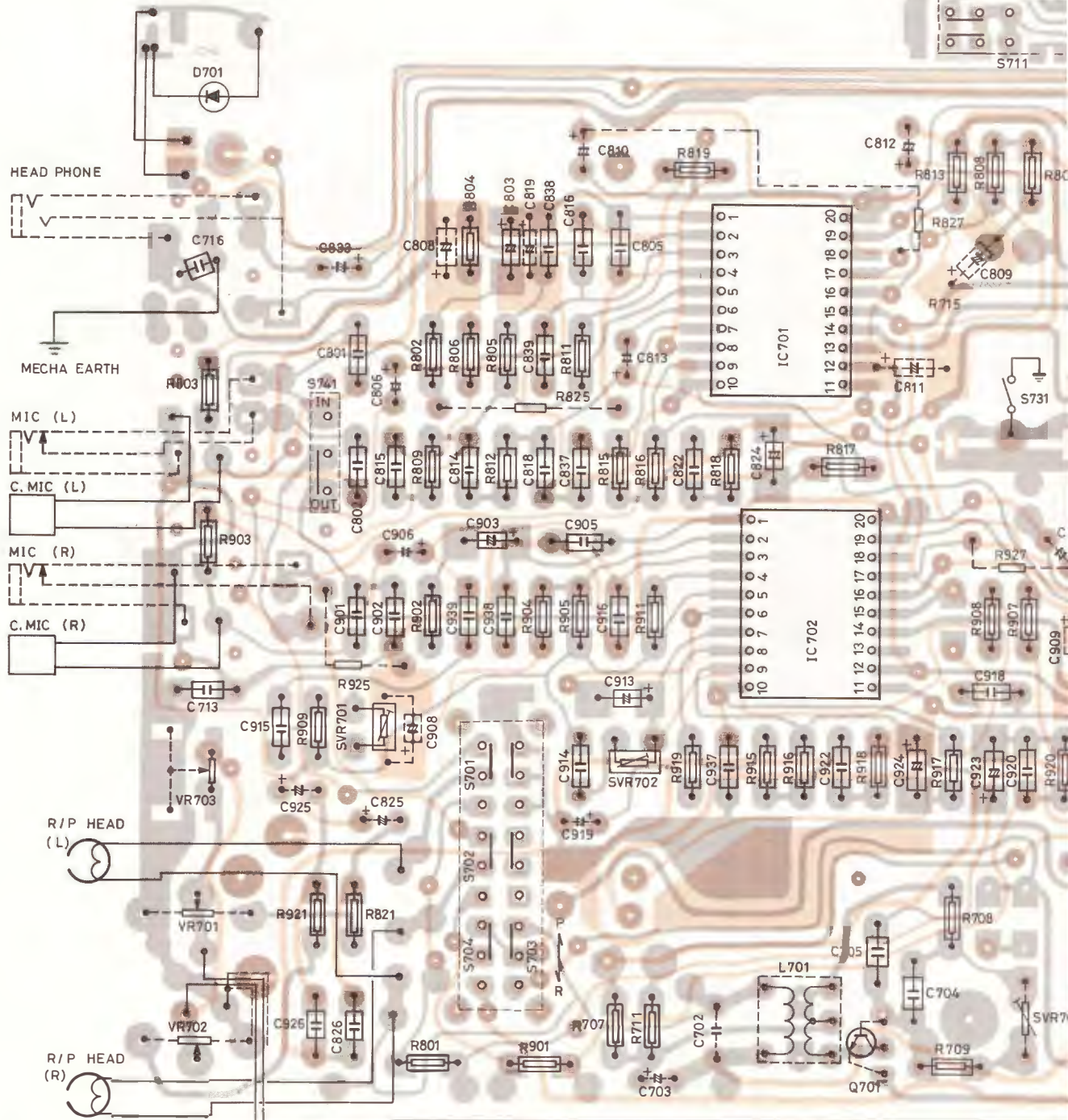

Q701,702,703...2SC536 (SP)

IC701,702...μP

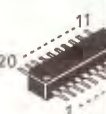

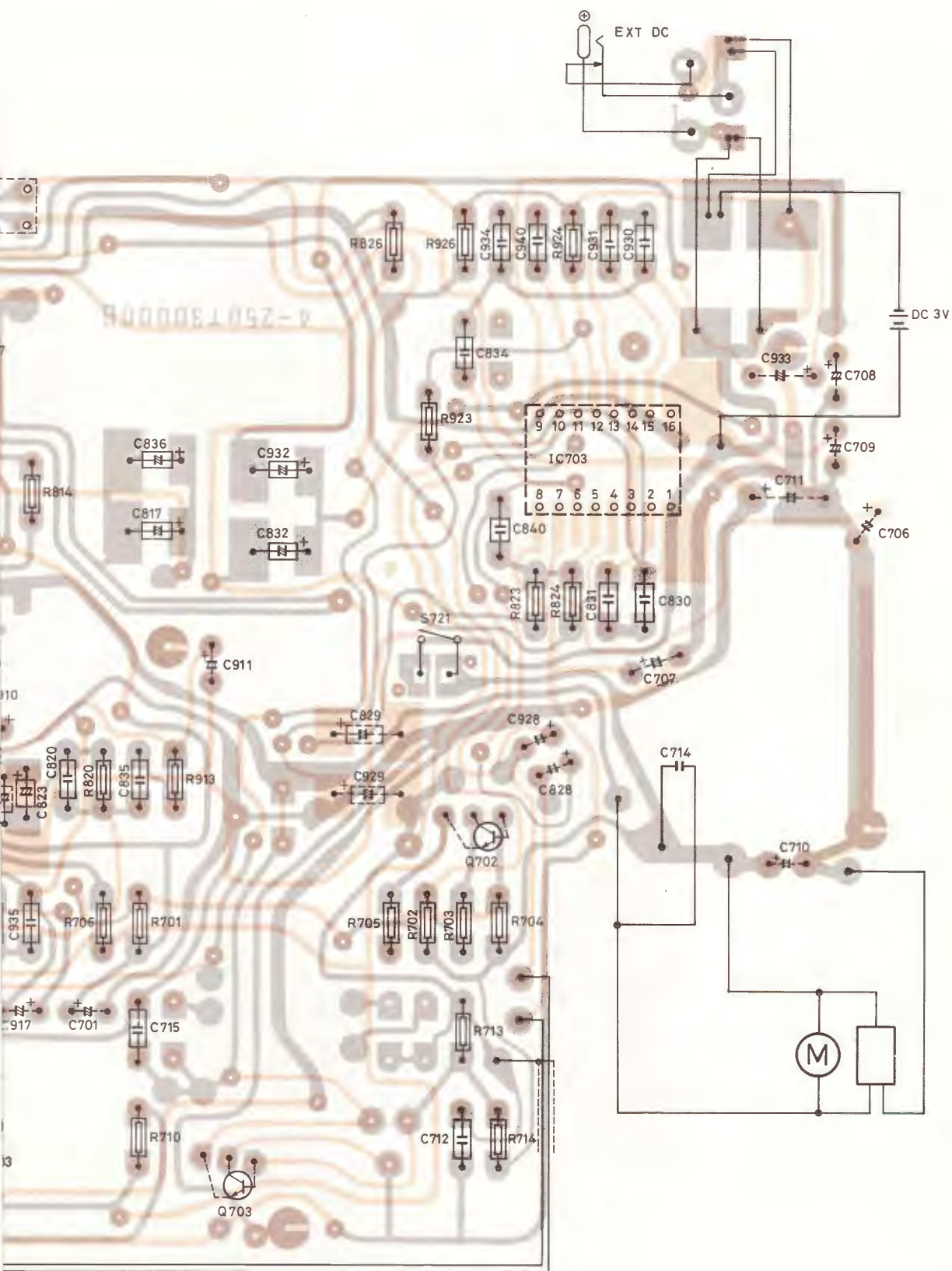

IC703 ----- KB4433

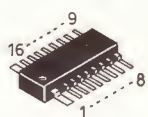

	1980	1981	1982	1983	1984	1985	1986	1987	1988	1989	1990	1991	1992	1993	1994	1995	1996	1997	1998	1999	2000	2001	2002	2003	2004	2005	2006	2007	2008	2009	2010	2011	2012	2013	2014	2015	2016	2017	2018	2019	2020	2021	2022	2023	2024	2025	2026	2027	2028	2029	2030	2031	2032	2033	2034	2035	2036	2037	2038	2039	2040	2041	2042	2043	2044	2045	2046	2047	2048	2049	2050	2051	2052	2053	2054	2055	2056	2057	2058	2059	2060	2061	2062	2063	2064	2065	2066	2067	2068	2069	2070	2071	2072	2073	2074	2075	2076	2077	2078	2079	2080	2081	2082	2083	2084	2085	2086	2087	2088	2089	2090	2091	2092	2093	2094	2095	2096	2097	2098	2099	2100	2101	2102	2103	2104	2105	2106	2107	2108	2109	2110	2111	2112	2113	2114	2115	2116	2117	2118	2119	2120	2121	2122	2123	2124	2125	2126	2127	2128	2129	2130	2131	2132	2133	2134	2135	2136	2137	2138	2139	2140	2141	2142	2143	2144	2145	2146	2147	2148	2149	2150	2151	2152	2153	2154	2155	2156	2157	2158	2159	2160	2161	2162	2163	2164	2165	2166	2167	2168	2169	2170	2171	2172	2173	2174	2175	2176	2177	2178	2179	2180	2181	2182	2183	2184	2185	2186	2187	2188	2189	2190	2191	2192	2193	2194	2195	2196	2197	2198	2199	2200	2201	2202	2203	2204	2205	2206	2207	2208	2209	2210	2211	2212	2213	2214	2215	2216	2217	2218	2219	2220	2221	2222	2223	2224	2225	2226	2227	2228	2229	2230	2231	2232	2233	2234	2235	2236	2237	2238	2239	2240	2241	2242	2243	2244	2245	2246	2247	2248	2249	2250	2251	2252	2253	2254	2255	2256	2257	2258	2259	2260	2261	2262	2263	2264	2265	2266	2267	2268	2269	2270	2271	2272	2273	2274	2275	2276	2277	2278	2279	2280	2281	2282	2283	2284	2285	2286	2287	2288	2289	2290	2291	2292	2293	2294	2295	2296	2297	2298	2299	2300	2301	2302	2303	2304	2305	2306	2307	2308	2309	2310	2311	2312	2313	2314	2315	2316	2317	2318	2319	2320	2321	2322	2323	2324	2325	2326	2327	2328	2329	2330	2331	2332	2333	2334	2335	2336	2337	2338	2339	2340	2341	2342	2343	2344	2345	2346	2347	2348	2349	2350	2351	2352	2353	2354	2355	2356	2357	2358	2359	2360	2361	2362	2363	2364	2365	2366	2367	2368	2369	2370	2371	2372	2373	2374	2375	2376	2377	2378	2379	2380	2381	2382	2383	2384	2385	2386	2387	2388	2389	2390	2391	2392	2393	2394	2395	2396	2397	2398	2399	2400	2401	2402	2403	2404	2405	2406	2407	2408	2409	2410	2411	2412	2413	2414	2415	2416	2417	2418	2419	2420	2421	2422	2423	2424	2425	2426	2427	2428	2429	2430	2431	2432	2
--	------	------	------	------	------	------	------	------	------	------	------	------	------	------	------	------	------	------	------	------	------	------	------	------	------	------	------	------	------	------	------	------	------	------	------	------	------	------	------	------	------	------	------	------	------	------	------	------	------	------	------	------	------	------	------	------	------	------	------	------	------	------	------	------	------	------	------	------	------	------	------	------	------	------	------	------	------	------	------	------	------	------	------	------	------	------	------	------	------	------	------	------	------	------	------	------	------	------	------	------	------	------	------	------	------	------	------	------	------	------	------	------	------	------	------	------	------	------	------	------	------	------	------	------	------	------	------	------	------	------	------	------	------	------	------	------	------	------	------	------	------	------	------	------	------	------	------	------	------	------	------	------	------	------	------	------	------	------	------	------	------	------	------	------	------	------	------	------	------	------	------	------	------	------	------	------	------	------	------	------	------	------	------	------	------	------	------	------	------	------	------	------	------	------	------	------	------	------	------	------	------	------	------	------	------	------	------	------	------	------	------	------	------	------	------	------	------	------	------	------	------	------	------	------	------	------	------	------	------	------	------	------	------	------	------	------	------	------	------	------	------	------	------	------	------	------	------	------	------	------	------	------	------	------	------	------	------	------	------	------	------	------	------	------	------	------	------	------	------	------	------	------	------	------	------	------	------	------	------	------	------	------	------	------	------	------	------	------	------	------	------	------	------	------	------	------	------	------	------	------	------	------	------	------	------	------	------	------	------	------	------	------	------	------	------	------	------	------	------	------	------	------	------	------	------	------	------	------	------	------	------	------	------	------	------	------	------	------	------	------	------	------	------	------	------	------	------	------	------	------	------	------	------	------	------	------	------	------	------	------	------	------	------	------	------	------	------	------	------	------	------	------	------	------	------	------	------	------	------	------	------	------	------	------	------	------	------	------	------	------	------	------	------	------	------	------	------	------	------	------	------	------	------	------	------	------	------	------	------	------	------	------	------	------	------	------	------	------	------	------	------	------	------	------	------	------	------	------	------	------	------	------	------	------	------	------	------	------	------	------	------	------	------	------	------	------	------	------	------	------	------	------	------	---

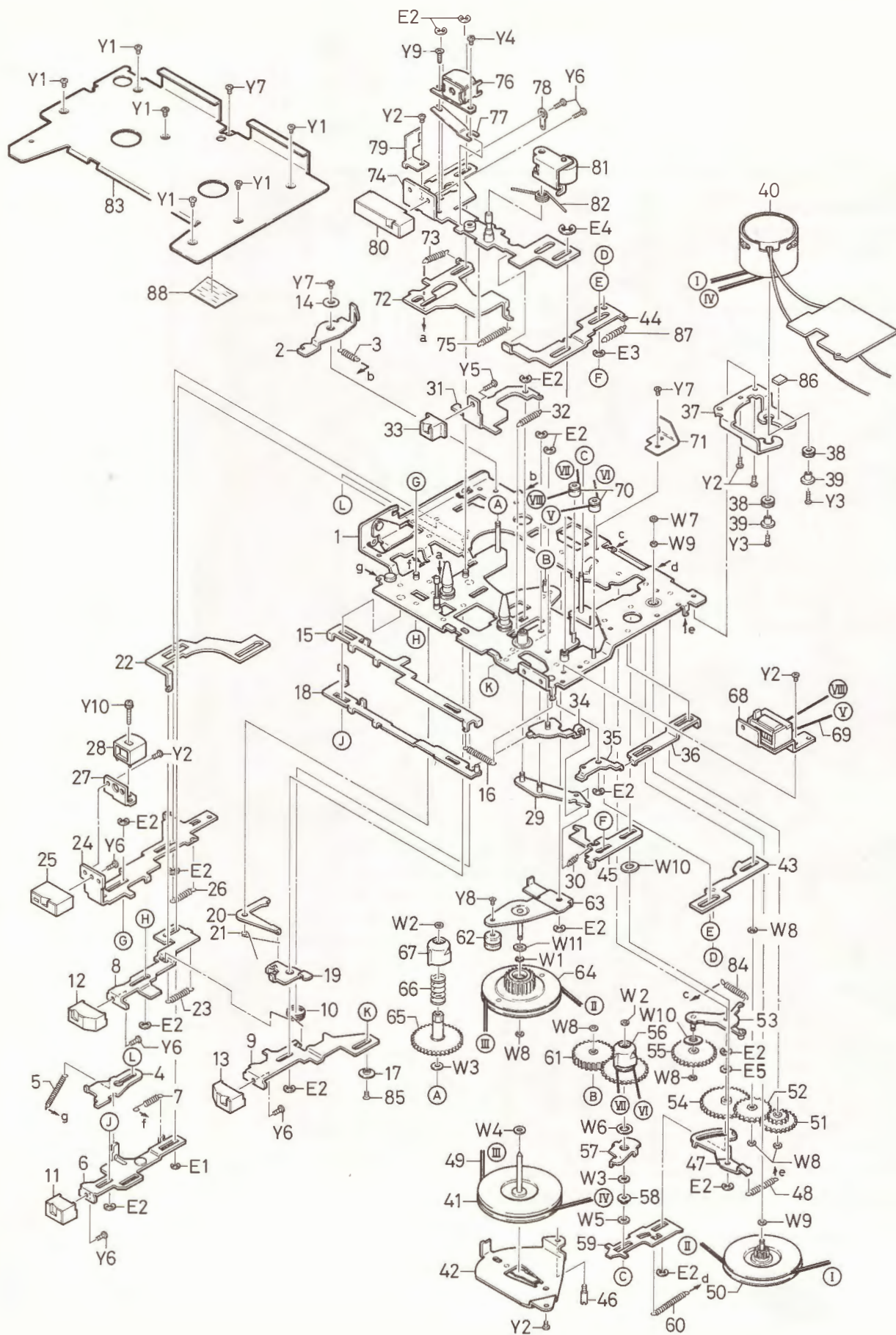

PARTS LIST

Key No.	Part No.	Description	Q'ty
MECHANISM (TM-S1)			
1	141-0-311T-40100	Chassis Ass'y	1
2	141-2-742T-79700	Lever	1
3	141-2-855T-92000	Spring Coil	1
4	141-2-742T-79900	Lever	1
5	141-2-855T-91900	Spring Coil	1
6	141-2-731T-98600	Slide	1
7	141-2-855T-91700	Spring Coil	1
8	141-2-731T-98700	Slide	1
9	141-2-731T-98900	Slide	1
10	141-2-852T-73800	Spring Wire	1
11	141-2-160T-02800	Push Button, S/E	1
12	141-2-160T-02900	Push Button, Rew	1
13	141-2-160T-03000	Push Button, FF	1
14	141-2-754T-17600	Shaft	1
15	141-2-731T-98400	Slide	1
16	141-2-855T-91500	Spring Coil	1
17	141-2-462T-72900	Boss	1
18	141-0-731T-98500	Slide Ass'y	1
19	141-2-742T-79500	Lever	1
20	141-2-742T-79300	Lever	1
21	141-2-852T-74000	Spring Wire	1
22	141-2-731T-98100	Slide	1
23	141-2-855T-91800	Spring Coil	1
24	141-0-731T-97800	Slide Ass'y	1
25	141-2-160T-02700	Push Button, Rec	1
26	141-2-855T-98700	Spring Coil	1
27	141-2-310T-74200	Bracket	1
28	4-242T-28800	E Head	1
29	141-0-742T-78800	Lever Ass'y	1
30	141-2-855T-91100	Spring Coil	1
31	141-2-731T-98200	Slide	1
32	141-2-855T-91400	Spring Coil	1
33	141-2-160T-02500	Push Button, Pause	1
34	141-0-742T-79000	Lever Ass'y	1
35	141-0-742T-79100	Lever Ass'y	1
36	141-2-731T-98800	Slide	1
37	141-2-378T-12101	Bracket, Motor	1
38	141-2-445T-27200	Rubber Cushion	2
39	141-2-461T-42000	Pipe	2
40	141-4-527T-18200	Motor W/PCB	1
41	141-0-521T-13400	Flywheel Ass'y	1
42	141-0-524T-10000	Bracket, Flywheel Ass'y	1
43	141-0-731T-97700	Slide Ass'y	1
44	141-2-731T-99000	Slide	1
45	141-2-731T-98000	Slide	1
46	141-2-417T-20700	Stud Nut	1
47	141-0-742T-79200	Lever Ass'y	1
48	141-2-855T-90900	Spring Coil	1
49	141-2-564T-26500	Square Belt	1
50	141-0-661T-34820	Pulley Ass'y	1
51	141-2-581T-23200	Gear	1
52	141-2-581T-23700	Gear	1
53	141-0-742T-78700	Lever Ass'y	1
54	141-2-581T-23400	Gear	1
55	141-2-581T-23300	Gear	1
56	141-0-661T-34100	Pulley Ass'y	1
57	141-2-742T-78900	Lever	1
58	141-2-462T-70900	Boss	2
59	141-2-731T-97600	Slide	1
60	141-2-855T-91600	Spring Coil	1
61	141-2-581T-23500	Gear	1
62	141-2-462T-71101	Boss } or	1
	141-2-462T-71100	Boss }	
63	141-0-742T-79600	Lever Ass'y	1
64	141-0-661T-34000	Pulley Ass'y	1
65	141-2-581T-23100	Gear	1
66	141-2-855T-90700	Spring Coil	1
67	141-2-531T-13700	Reel Plate	1
68	141-0-812T-11100	Bracket, Counter Ass'y	1
69	141-2-564T-26600	Square Belt	1
70	141-2-661T-34200	Pulley	2
71	141-2-853T-75600	Spring Plate	1
72	141-2-731T-98300	Slide	1
73	141-2-855T-91300	Spring Coil	1
74	141-0-731T-97900	Slide Ass'y	1
75	141-2-855T-91200	Spring Coil	1
76	4-242T-28700	R/P Head	1
77	141-2-853T-75100	Spring Plate	1
78	141-2-472T-08600	Lug	1
79	141-2-821T-12900	Tape Guide	1
80	141-2-160T-02600	Push Button, Play	1
81	141-0-545T-07800	Lever Pinch Roller Ass'y	1

Key No.	Part No.	Description	Q'ty
MECHANISM (TM-S1)			
82	141-2-852T-73900	Spring Wire	1
83	141-2-853T-75200	Spring Plate	1
84	141-2-855T-91000	Spring Coil	1
85	141-2-421T-36700	Special Screw	1
86	141-2-447T-66700	Cushion 3x5x1t	2
87	141-2-855T-98800	Spring Coil	1
88	141-2-247T-03500	Sheet	1
MECHANISM HARDWARE			
Y01		Pan Hd. Screw 1.4x1.5	7
Y02		Pan Hd. Screw 1.7x2	5
Y03		Pan Hd. Screw 1.7x3.5	2
Y04		Pan Hd. Screw 2x2	1
Y05		Pan Hd. Tapping Screw 1.7x4	3
Y06		Pan Hd. Tapping Screw 1.7x4	4
Y07		Flat Hd. Screw 1.4x1.8	1
Y08		Flat Hd. Screw 1.7x3	1
Y09		Flat Hd. Screw 2x6	1
Y10		Pan Hd. Screw W/Spring Washer 2x8	1
E01	141-2-457T-23700	Special Washer 1.2mm	1
E02	141-2-457T-23800	Special Washer 1.5mm	14
E03	141-2-457T-23000	Special Washer 2mm	1
E04	141-2-457T-23600	Special Washer	2
E05	141-2-457T-41500	Special Washer	1
W01	141-2-453T-30000	Washer 1.7x3.2x0.13	3
W02	141-2-453T-30001	Washer 1.7x3.2x0.25 Nylon	4
W03	141-2-453T-30100	Washer 2.1x4x0.13 Nylon	2
W04	141-2-453T-30101	Washer 2.1x4x0.25 Nylon	5
W05	141-2-453T-30102	Washer 2.1x4x0.5 Nylon	1
W06	141-2-453T-30400	Washer 3.6x6x0.13	1
W07	141-2-453T-31500	Washer, Nylon 1.3x3.2x0.25	1
W08	141-2-453T-33600	Washer, Nylon	6
W09	141-2-453T-33800	Washer, Nylon	1
W10	141-2-453T-31202	Washer, Nylon 2.1x8.5x0.13	2
W11	141-2-453T-62600	Washer, Nylon 1.6x5x0.15	1

SANYO ELECTRIC INC.

1200, West Artesia Blvd.,

P.O. Box 5177

Compton California 90220

Mar./82/7000 EP Printed in Japan